

BESTÅ

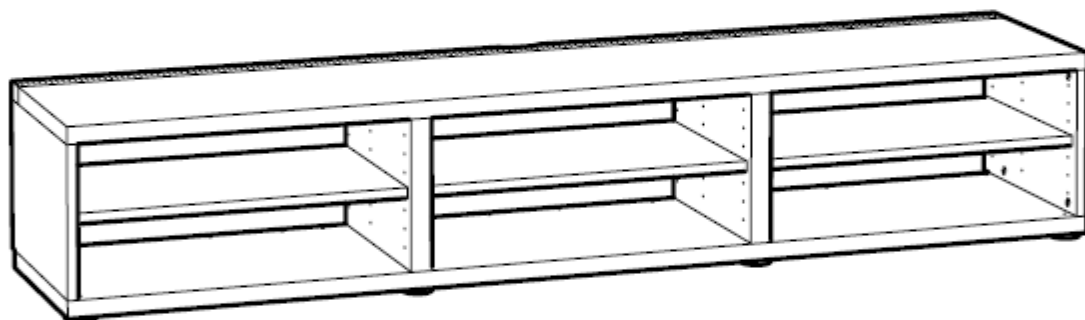

Design and Quality
IKEA of Sweden

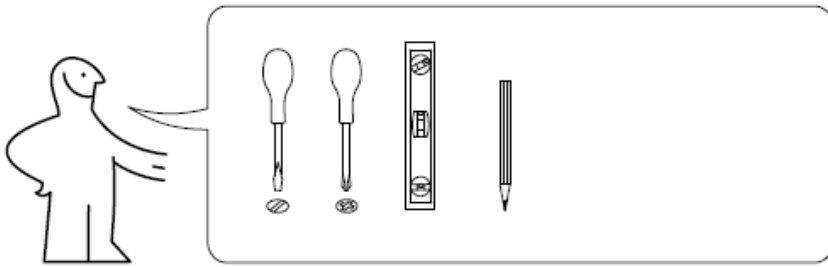

Tools Required for Assembly

- Flathead Screwdriver
- Philips Head Screwdriver
- Level
- Pencil

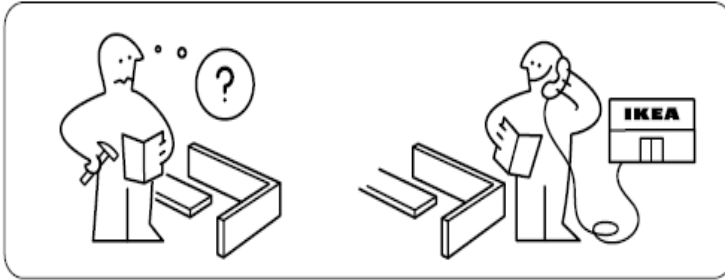

Assembly Help

- If you need help understanding how to assemble your new BESTA TV shelf contact IKEA.

Customer service:
1 (888) 888-4532

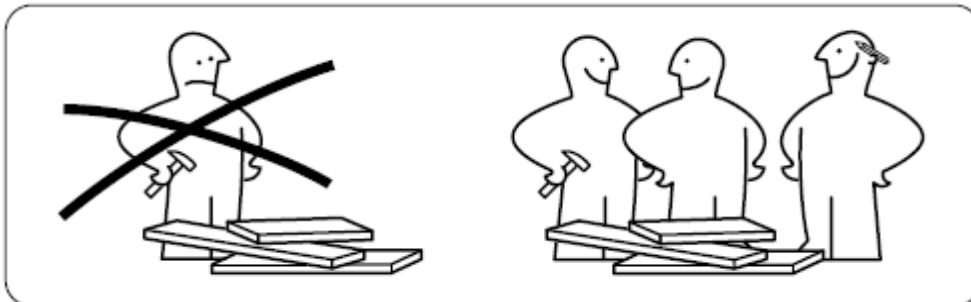

Warning

Assembly shouldn't be attempted alone

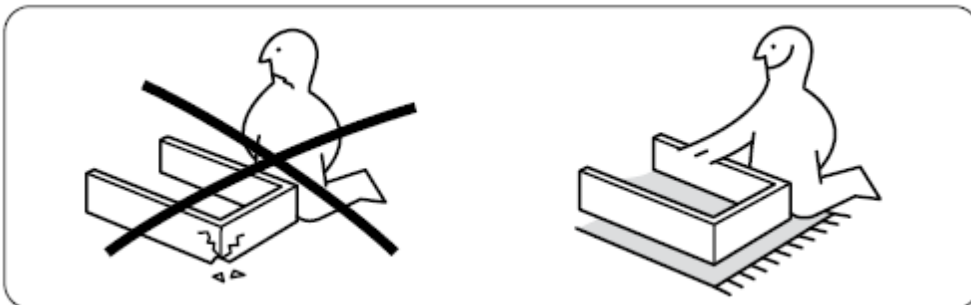

Caution

Assembly should be done on a soft surface to avoid breaking shelf edges

Parts List



114928

Extended head Screw
(part #114928) 16x

16x

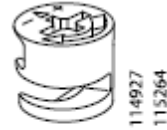

114927
115264

Small horizontal
screw (part
#114927/115264) x8

8x

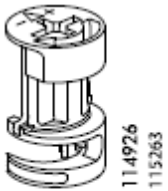

114926
115263

Large horizontal screw
(part #114926/115263)
x8

8x



113301

(part #113301) x12

12x

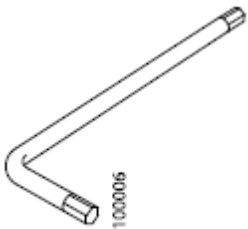

100006

Hex head Allen wrench
(part #100006) x1

1x

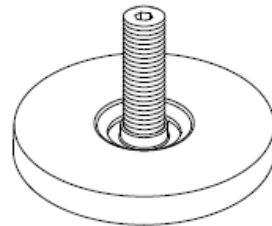

114947
115988

Shelf base screw
(part #114947
115988) x8

8x

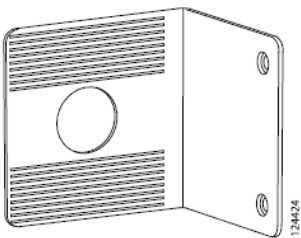

124424

Large L-Bracket (part
#124424) x4

4x



113287

Screw (part
#113287) x8

8x

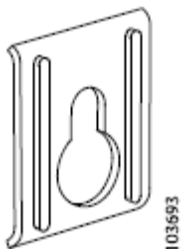

103693

Hanger (Part #103693)
x4

4x

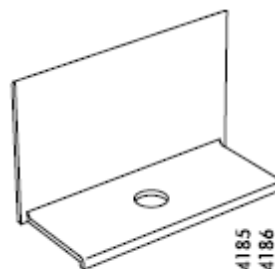

124185
124186

L-Bracket
(Part #124185
124186) x2

2x



2x

Pointed Screw (part #109049) x2

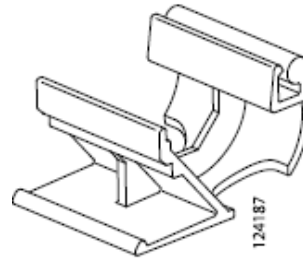

8x

Slotted Strip Holder (Part #124187) x8

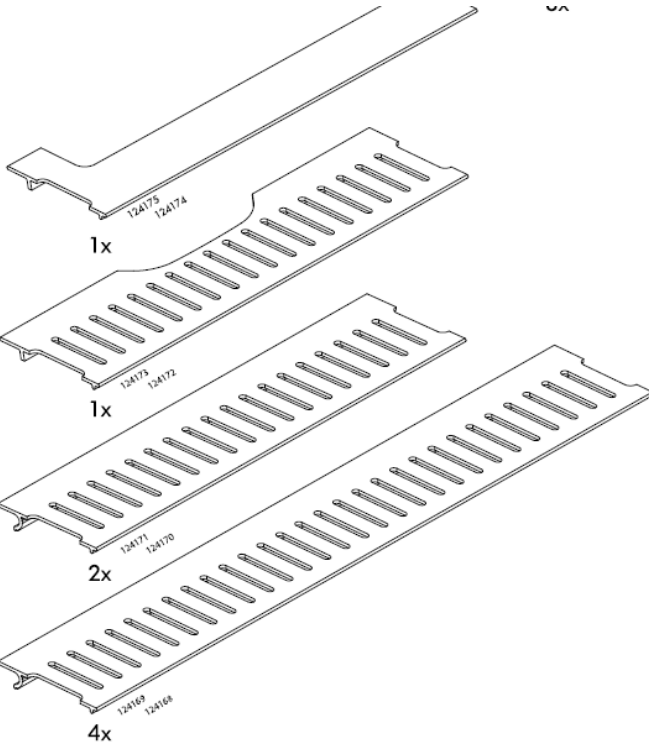

Strip (Part #124175/124174) x1

Slotted Strip (Part #124173/124172) x1

Slotted Strip (Part #124171/124170) x2

Long Slotted Strip (Part #124169/124168) x4

Assembly Instructions

Note: If you are wall mounting this piece, you will not need the 8 Shelf base screws.

Step 1

- A. Before assembling, turn base piece upside down

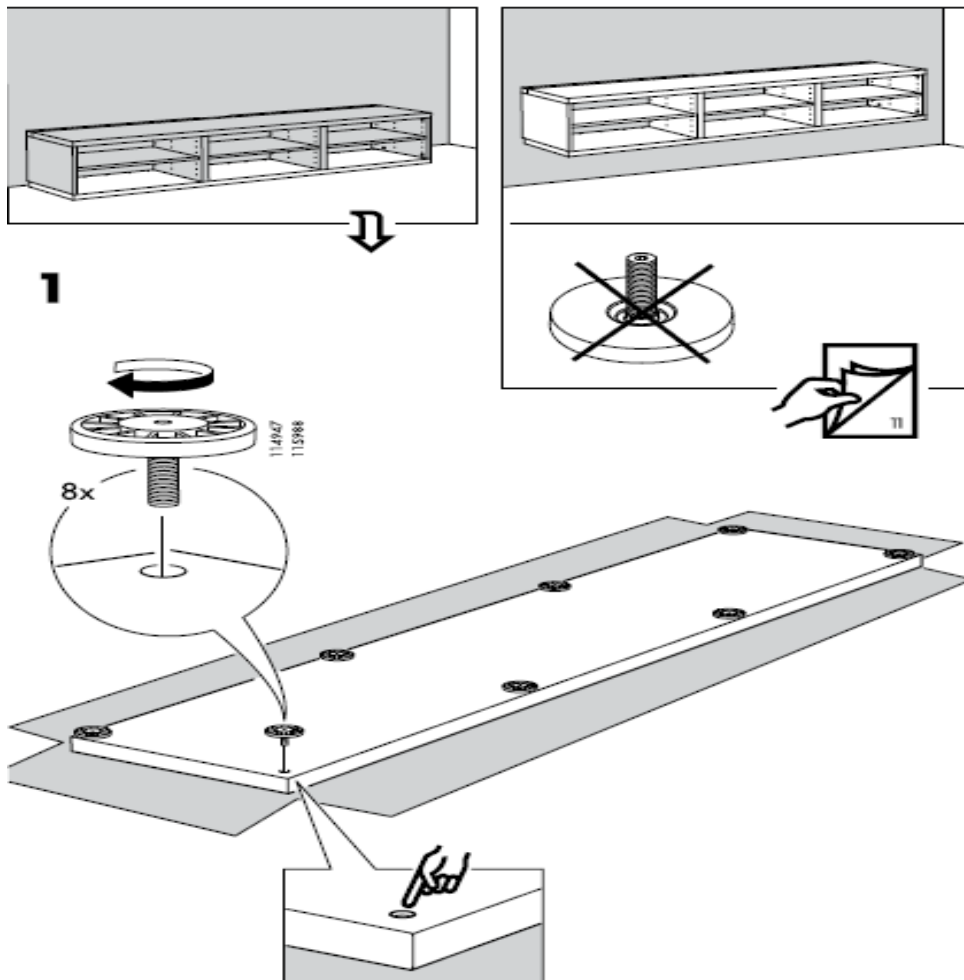

- B. Attach 8 Shelf base screws (part #114947 115988) to all screw holes in the base piece of the shelf.

2

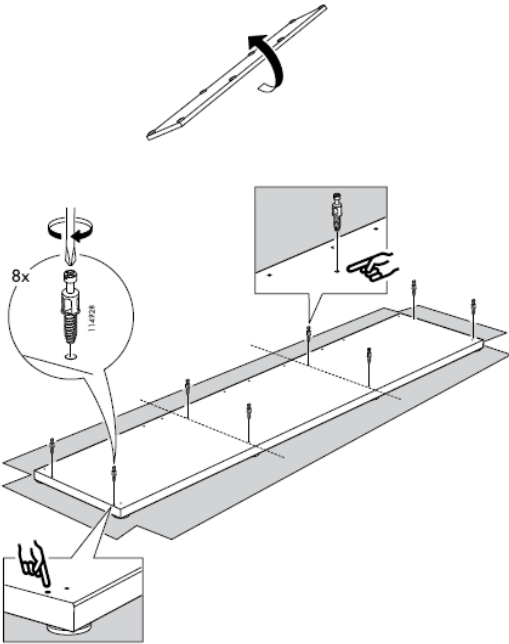

Step 2

Turn the base piece back upright, and place the 8 screws (part #113287) into the 8 holes positioned along the long sides of the base piece.

NOTE: These are positioned on both long sides at both ends and 1/3 and 2/3 of the length (4 per side as shown to the left).

3

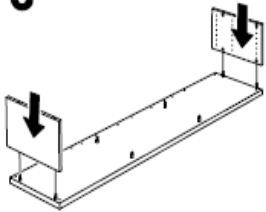

Step 3

A. Attach both vertical end pieces to the outside sets of screws from Step 2.

B. Attach 4 small horizontal screw heads (part #114927 115624) into the holes at the base of the vertical end pieces, 2 per side as shown to the left.

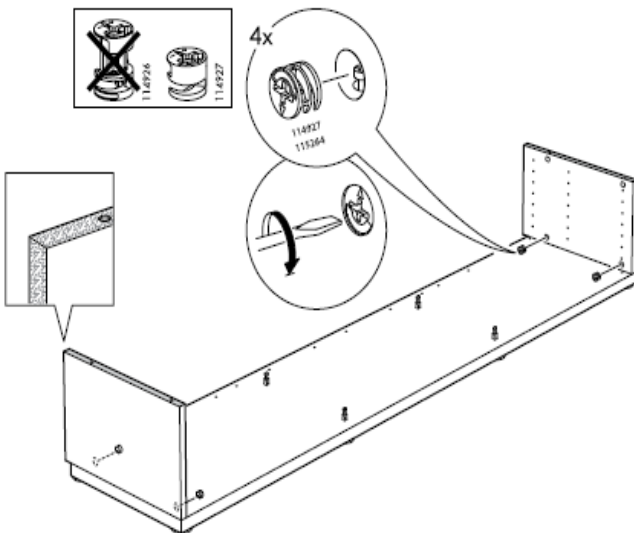

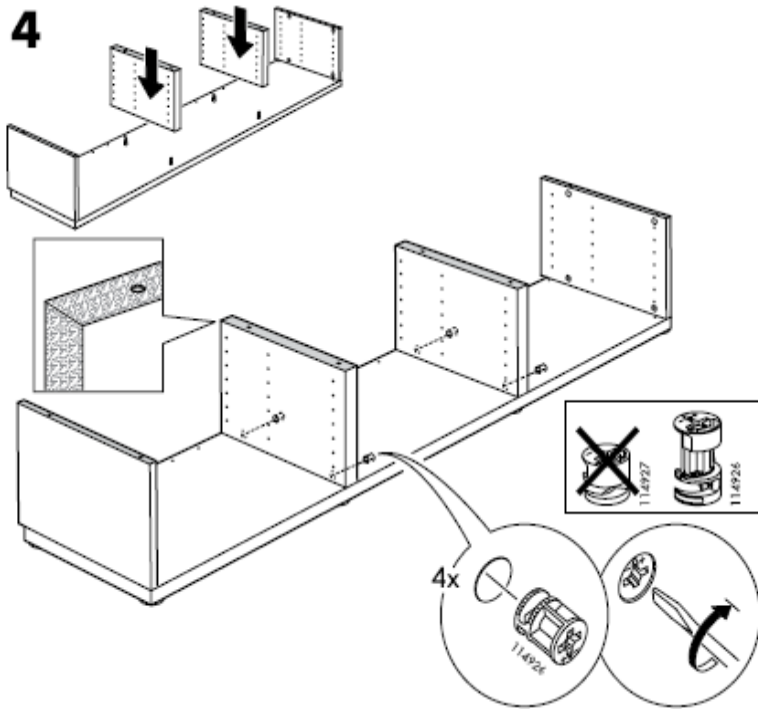

Step 4

- A. Attach two more vertical shelf pieces on the remaining two sets of screws in the base,
- B. Screw in two large horizontal screws (part #114926 115263) into each piece as shown to the left.

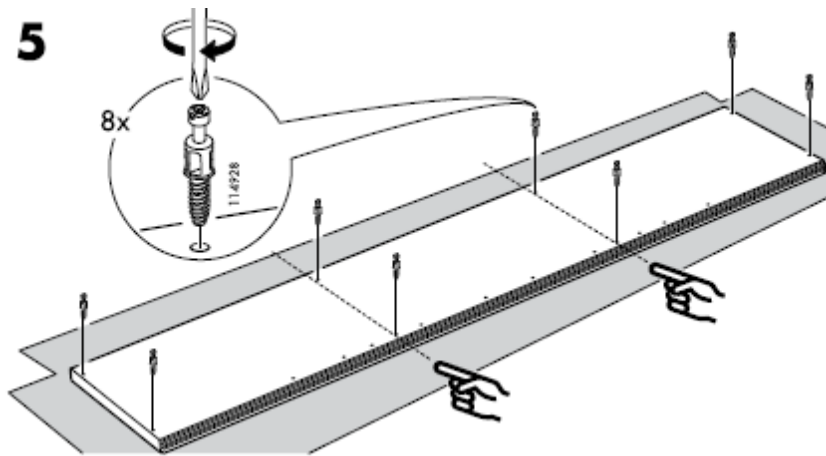

Step 5

Now take the top piece of the shelf and screw in the 8 remaining extended head screws (part #114928) from the top side as shown to the left.

6

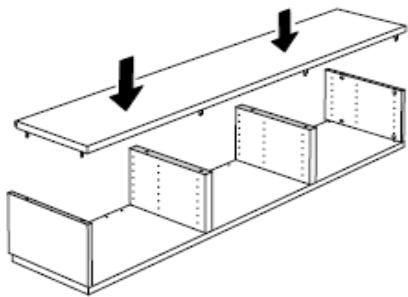

Step 6

- A. Take the top piece of the shelf and attach it to the rest of the shelf, leaving a small gap along the back side as shown above on the left.
- B. Take your 4 remaining large horizontal screws (part #114926, 115263) and attach them to the top side of the 2 inside vertical pieces.

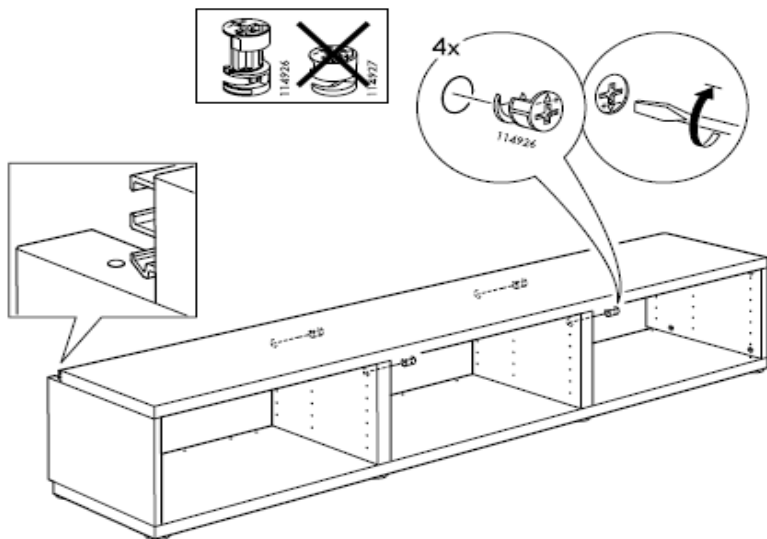

Step 7

- A. Insert the small horizontal screws (#114927) into the top holes on either end of the shelf.
- B. Put the screw in with the small arrow pointing up.
- C. Use a screwdriver to screw it in until the arrow points down.

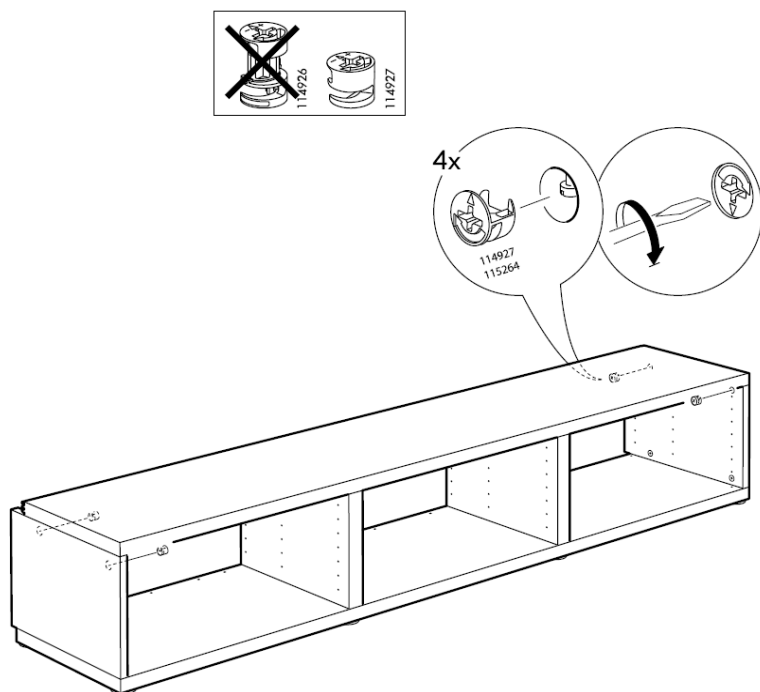

Step 8

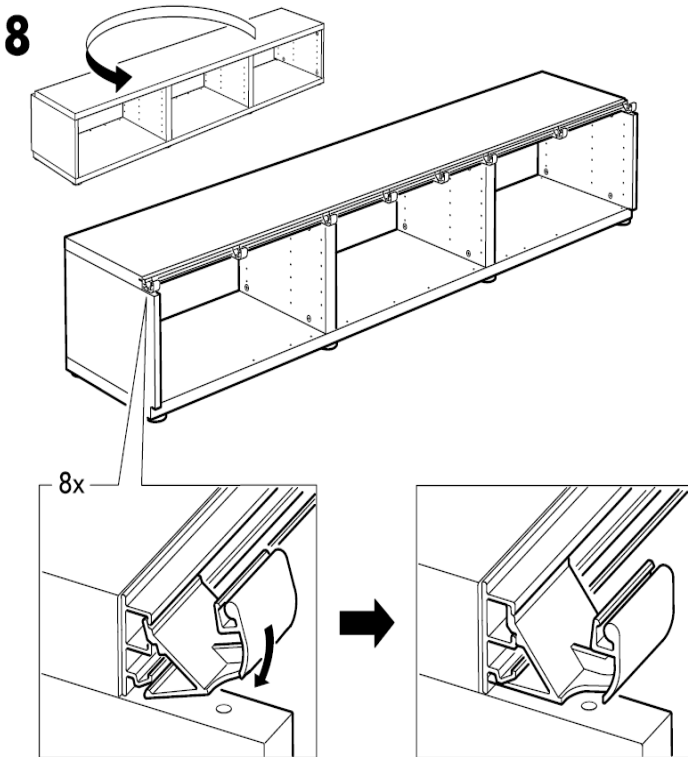

- A. Rotate the shelf 180 degrees so that the slider bar faces you.
- B. Place the clips (#124187) on the slider bar by putting the top lip in the top compartment, then rotating the clip downwards into the bottom compartment until it clicks in. Refer to the picture on the left.
- C. Place one clip above each vertical support piece, along with one directly in the middle of each outer segment, and two pieces in the middle of the center segment, splitting the center segment into thirds.

Step 9

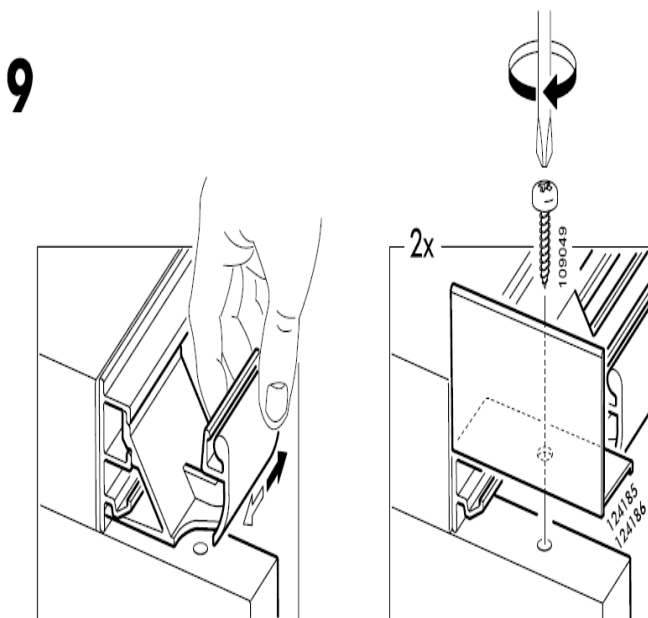

- A. Slide the clip that was just placed a few inches away from the end.
- B. Screw down the L shaped piece (#124185 and 124186).
- C. Line up the holes on the shelf and L shaped piece and have the vertical part of the L shaped piece line up with the outside of the shelf.
- D. Use the pointed screws (#109049). Slide the clip back until it touches the piece that was just placed.
- E. Repeat this step on the other end.

10

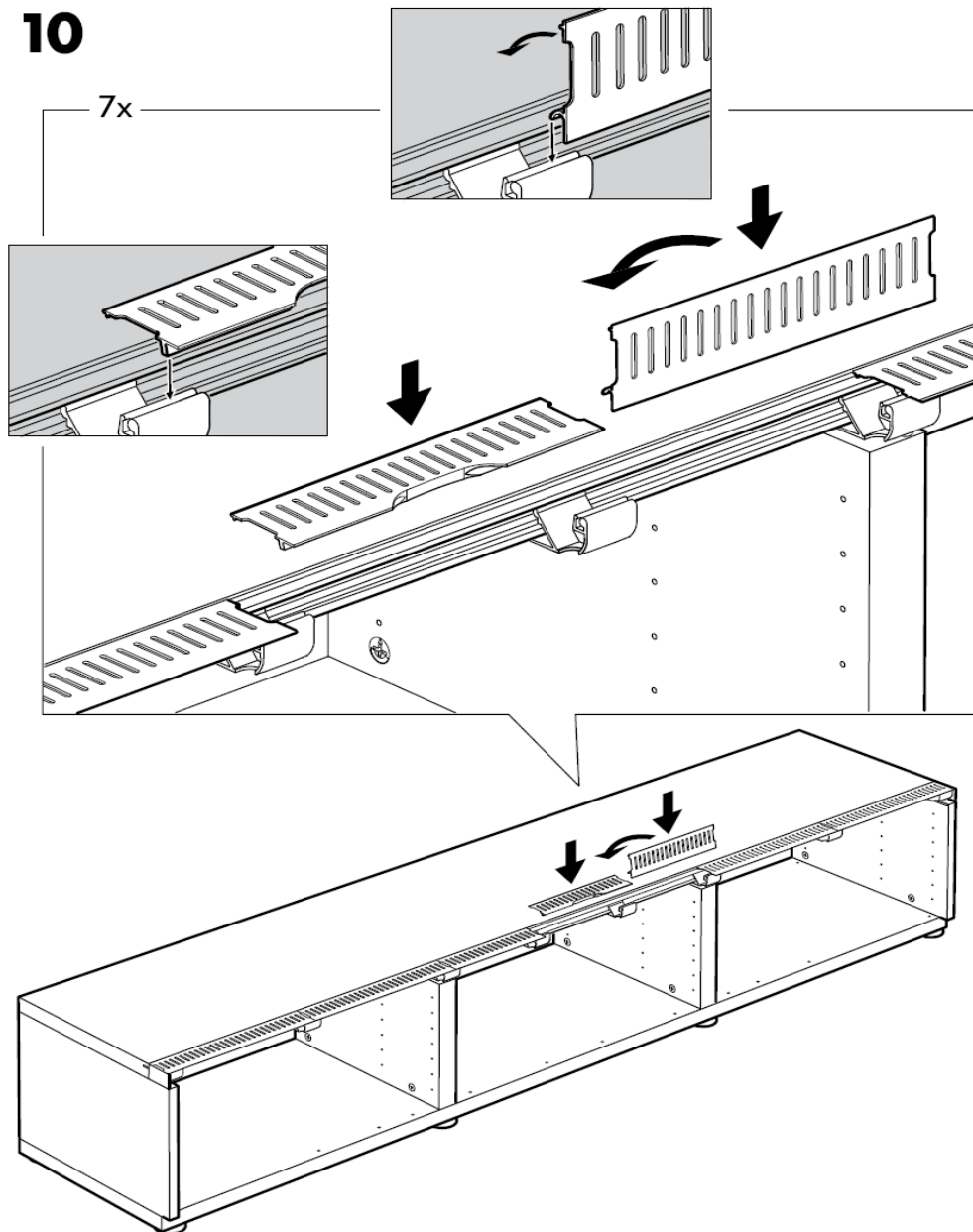

Step 10

- A. Attach the flat pieces with slots (#124168 - #124173). The longest pieces (#124168 and 124169) go all the way at the end with two on each side. Attach them to the clips by positioning the pieces vertically with the hooks on the bottom and facing towards the shelf. Push them into the clip and then rotate them down so that they cover up the clip from the top.
- B. Place the smaller pieces (#124170 and 124171) just inside the ones you just placed using the same method.
- C. The last piece with the lip (#124172 and 124173) goes directly in the center of the shelf. It can just be placed flat the lip on the outside. The notch on the bottom should fit into the clip.
- D. Make sure that each clip is spaced so that it is connected to two flat pieces on the ends.

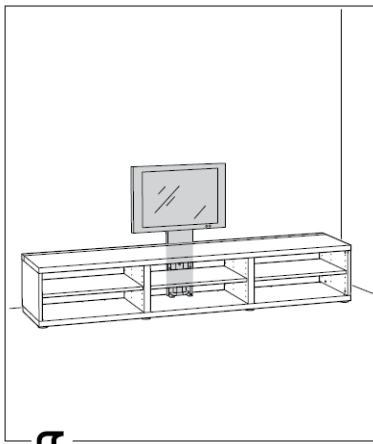

Note: If you want to mount a television to the shelf, consult the UPPLEVA manual.

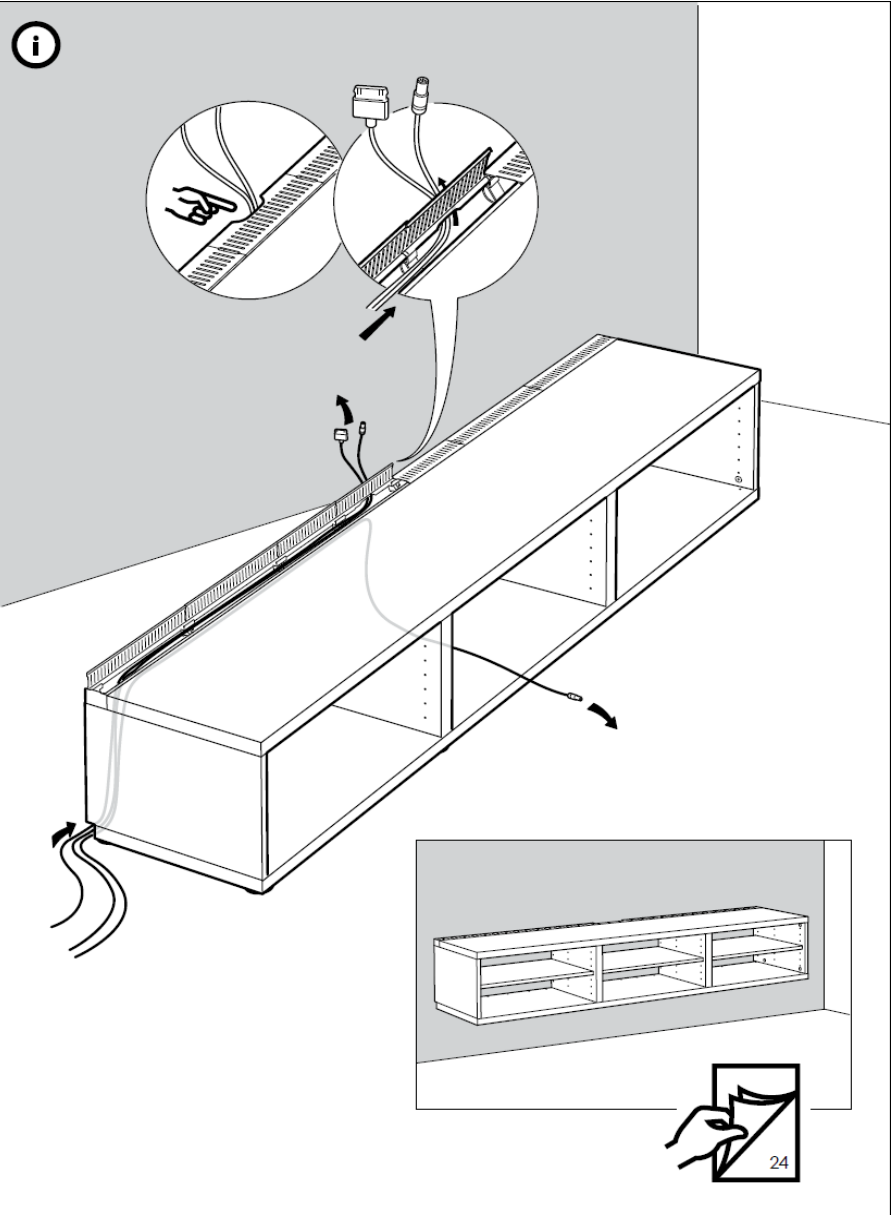
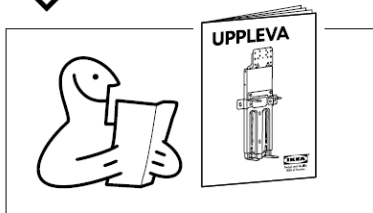

(i) Cords can go in between the clips and the slotted pieces as shown to the left.

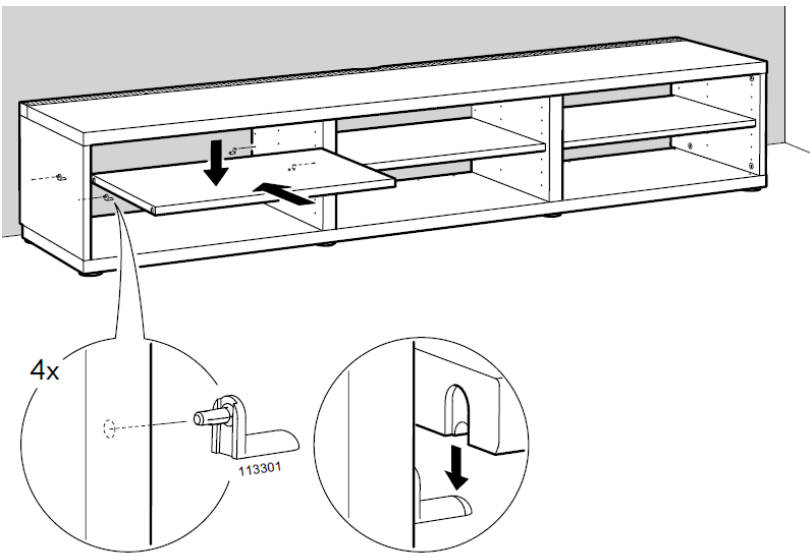

Step 11

Insert the shelf pegs (#113301) into the holes on the inside of the shelf at desired height. Place shelf piece on top of pegs and slip the holes over the shelf pegs.



Note: For leg attachment instructions, see the *BESTA Leg Manual*.

Warning: Do not throw the instructions away.

BESTÅ

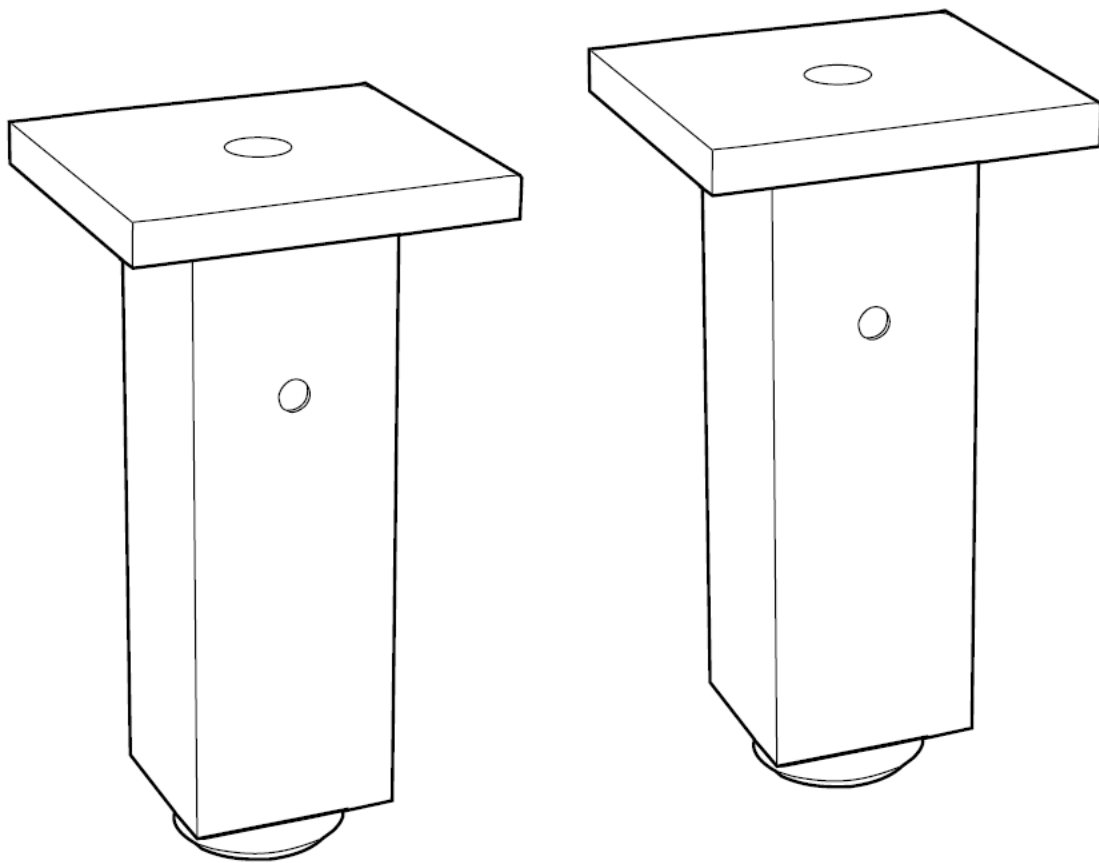

Design and Quality
IKEA of Sweden



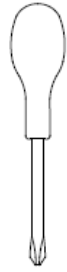

Tools Required for Assembly

- Philips Head Screwdriver

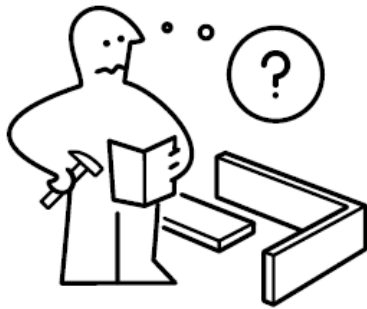

Assembly Help

- For assistance assembling your BESTA, contact IKEA. **Customer service:**
1 (888) 888-4532

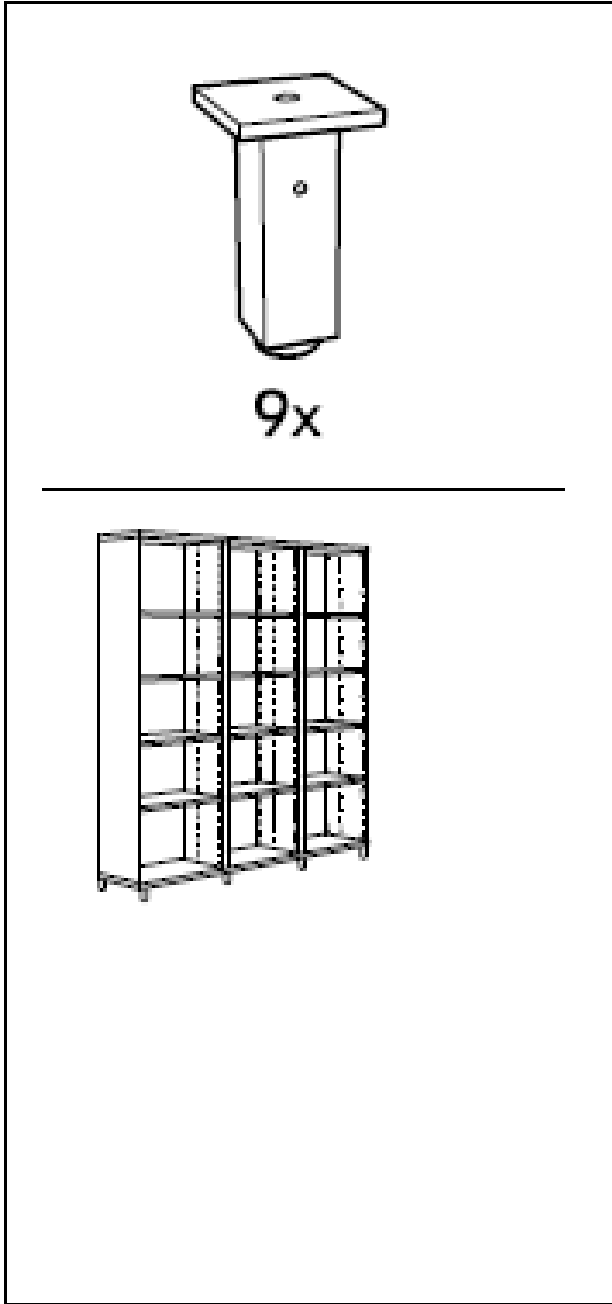

This BESTA leg set comes with 9 leg assemblies, but note that you may only need 8 legs to properly assemble your cabinet. Contains 9 leg bases and 9 leg extensions

Parts List

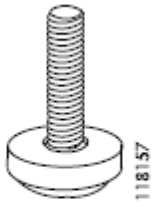

Leveling screw
(part #118157) x2

2x

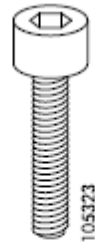

Hex head screw
(part #105323) x2

2x



Small Phillips head
screw (part
#106632) x2

2x

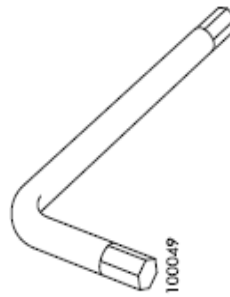

Hex head Allen
wrench (part
#100049) x1

1x

Assembly Instructions

1

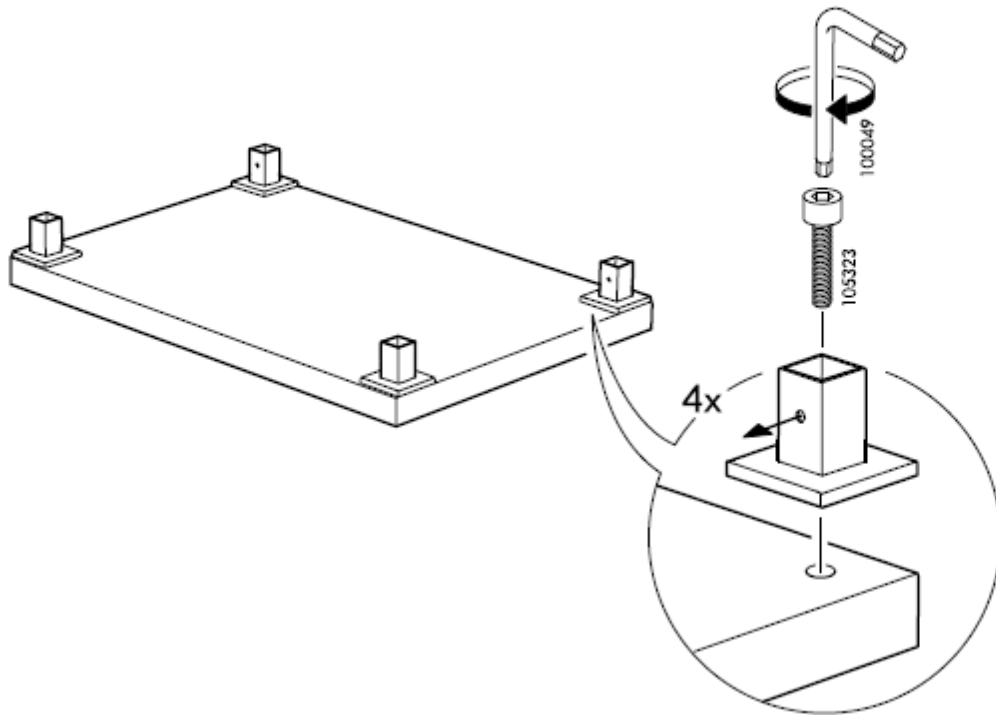

Step 1

- A. Before assembling legs on cabinet, turn cabinet upside down in order to attach legs.
- B. Use the Allen wrench (#100049) to attach leg base to bottom of cabinet using hex head screw (#105323) to secure. Repeat process for all 4 legs.

2

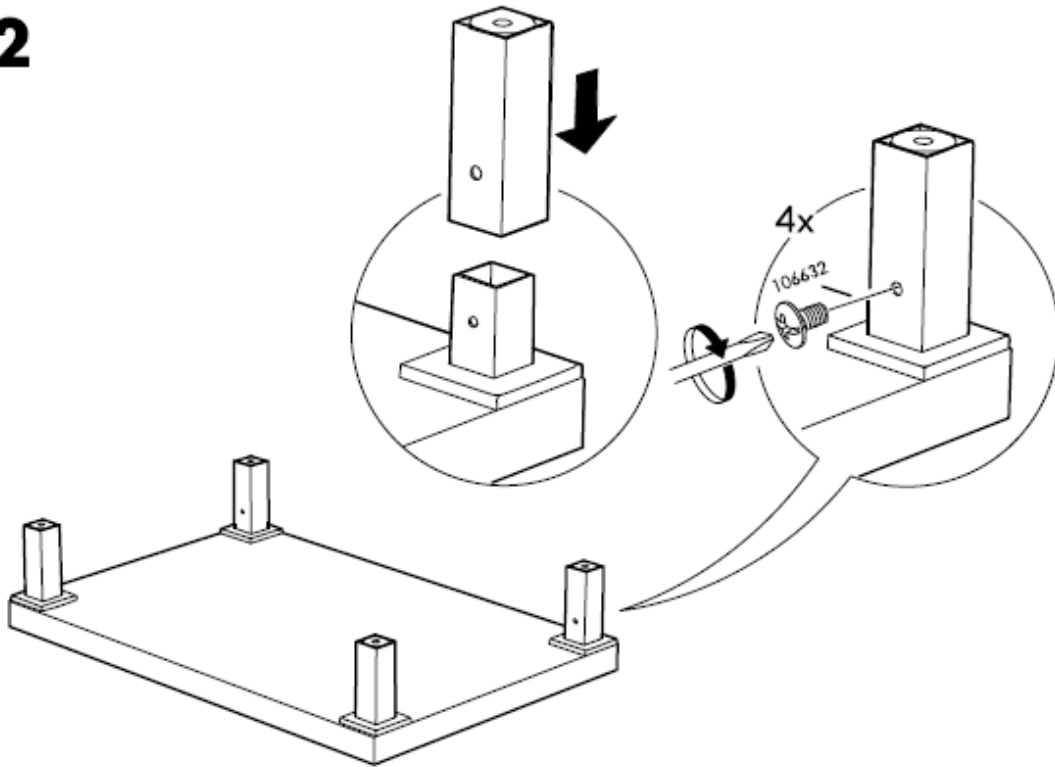

Step 2

Slide leg extensions over leg base and secure with the small Phillips screw (#106632) place in the side of the leg extension. Repeat this step for all 4 leg

3

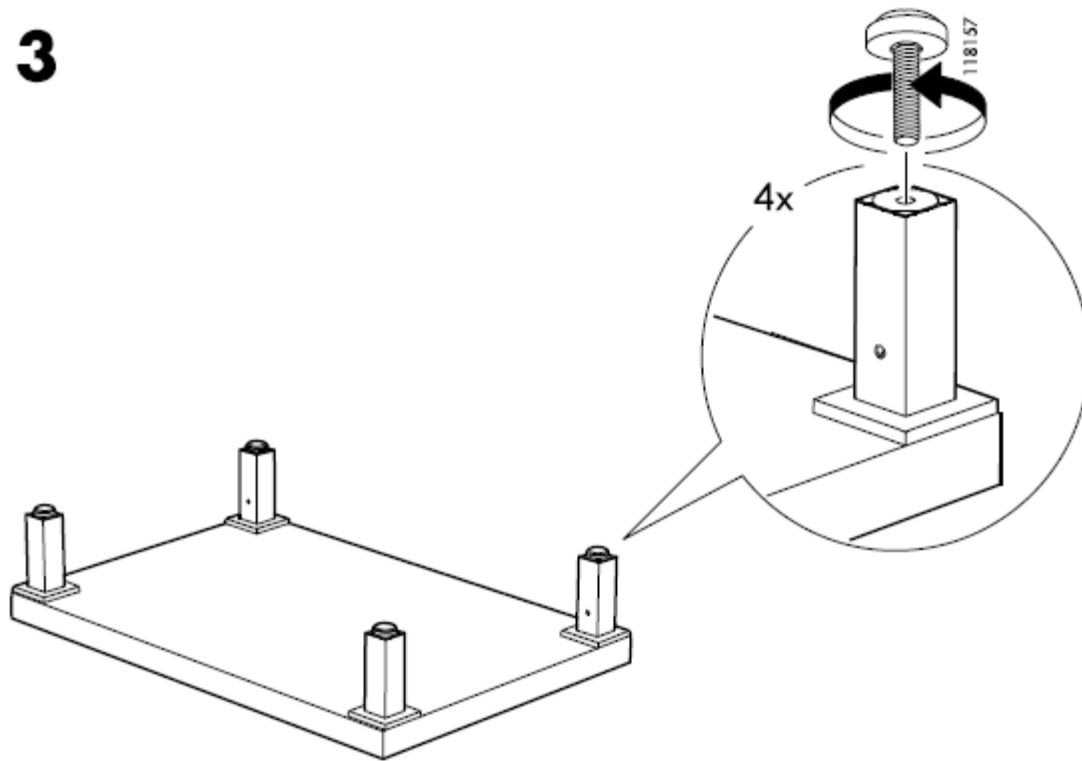

Step 3

- A. Place leveling screw (#118157) in the end of the leg extension. Turn in at least four (4) turns. Repeat for all 4 leg extensions.

- B. Once legs are securely attached, turn cabinet back to its right side up position and used leveling screws to stabilize cabinet.

POÄNG



Design and Quality
IKEA of Sweden



Tools Required for Assembly

- Philips Head Screwdriver

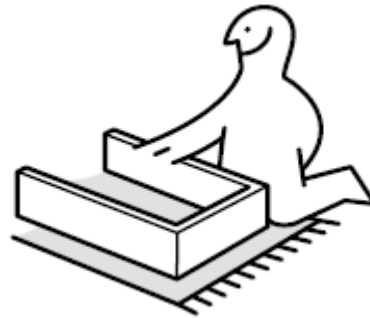
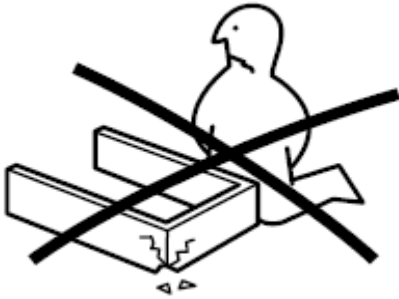

Warning

- Place assembly parts on a mat or rug to avoid damage due to impact with a hard surface.



Assembly Help

- For assistance assembling your POANG, contact IKEA. **Customer service:** 1 (888) 888-4532

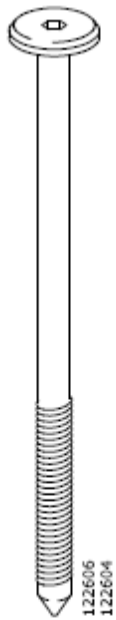

Long shank screw (part #122606) 4x

4x

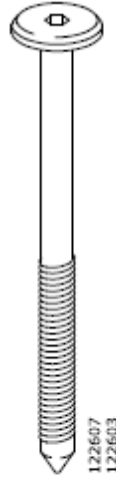

Short shank screw (part #122607/122603) 2x

2x

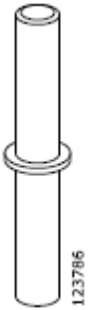

Alignment pin (part #123785) 2x

2x

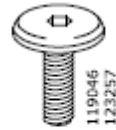

Small hex screw (part #119046) 8x

8x

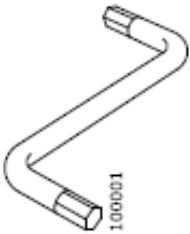

Hex head Allen Wrench (part #100001) 1x

1x

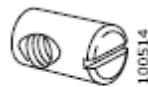

Anchor nut (part #100514) 4x

4x



Spacing washer (Part #102319) 2x

2x



Tapered head screw (part #112522) 6x

6x

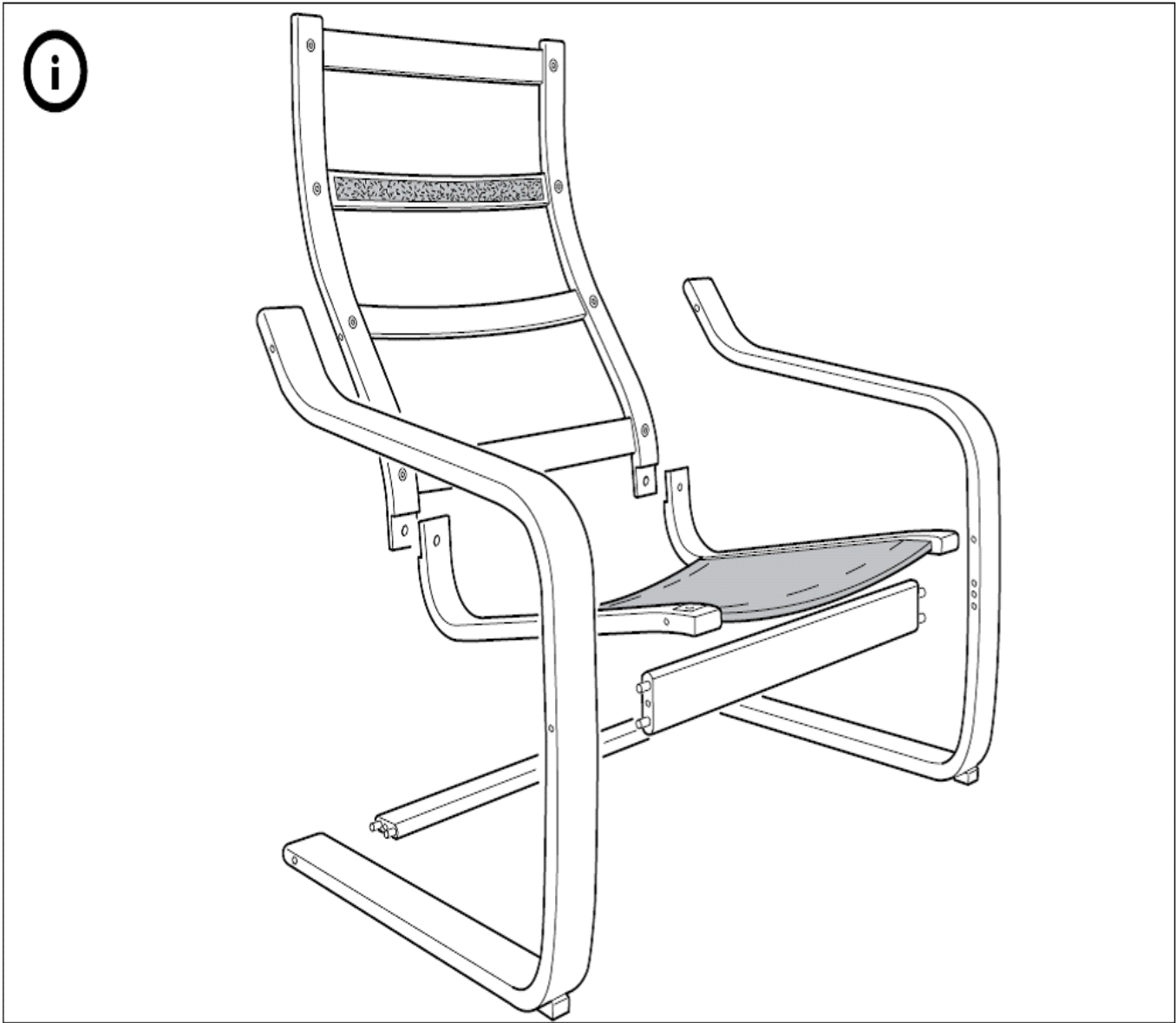

(i) This picture shows the placement of all the pieces in the final assembly.

1

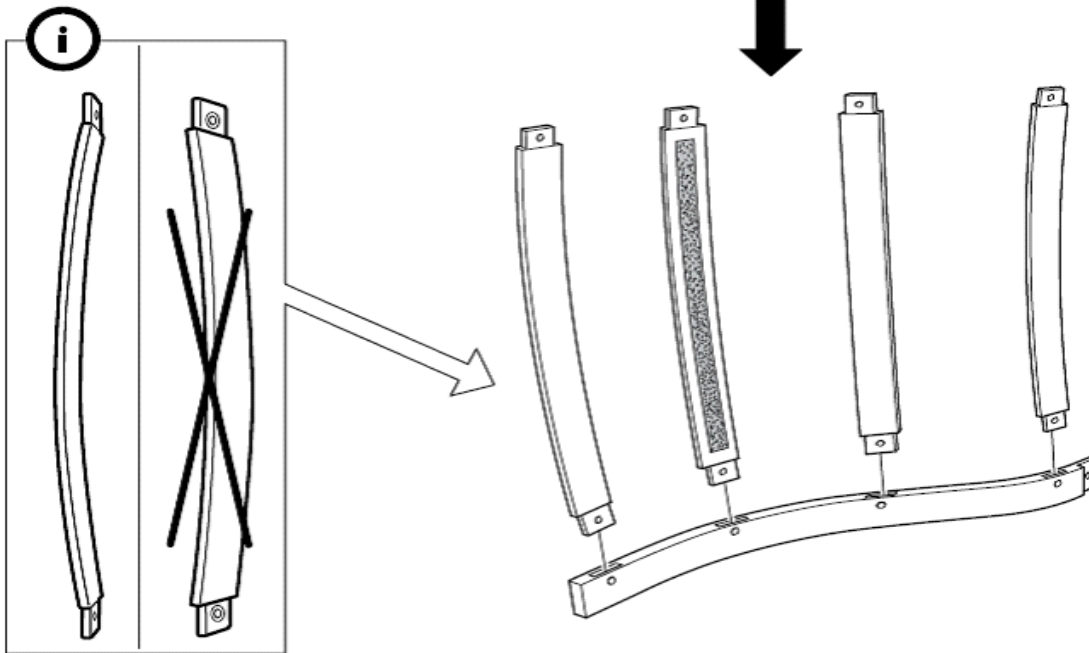

Step 1

Insert the mounting tabs of the four backrest rails into one of the side rails. Make sure that the one with the grip strip is positioned under the top rail. Make sure that the rails are oriented as shown in picture (i) above.

2

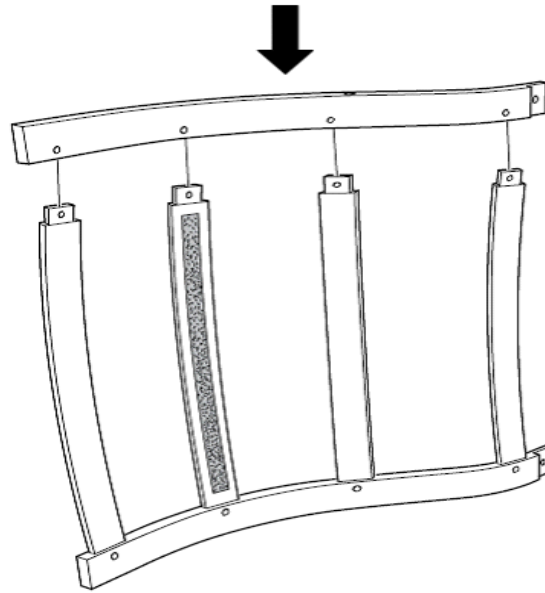

Step 2

Insert the other mounting tabs of the backrest rails into the other side rail.

3

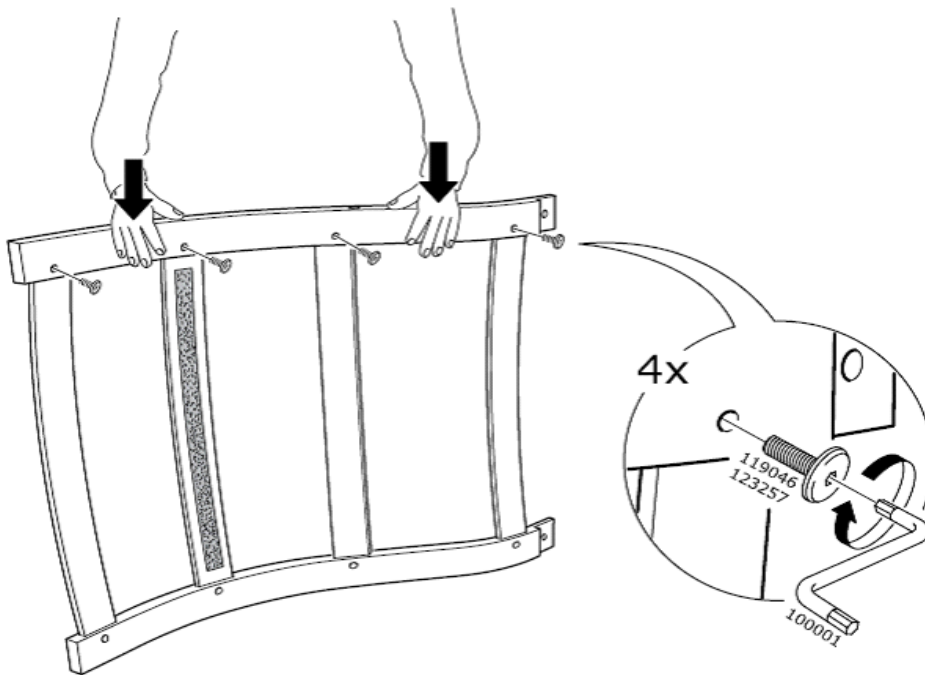

Step 3

Insert the small hex screw (#119046) through the side backrest rail hole and start threads by hand. Use the Allen wrench (#100001) to tighten the screw. Repeat for all 4 holes.

4

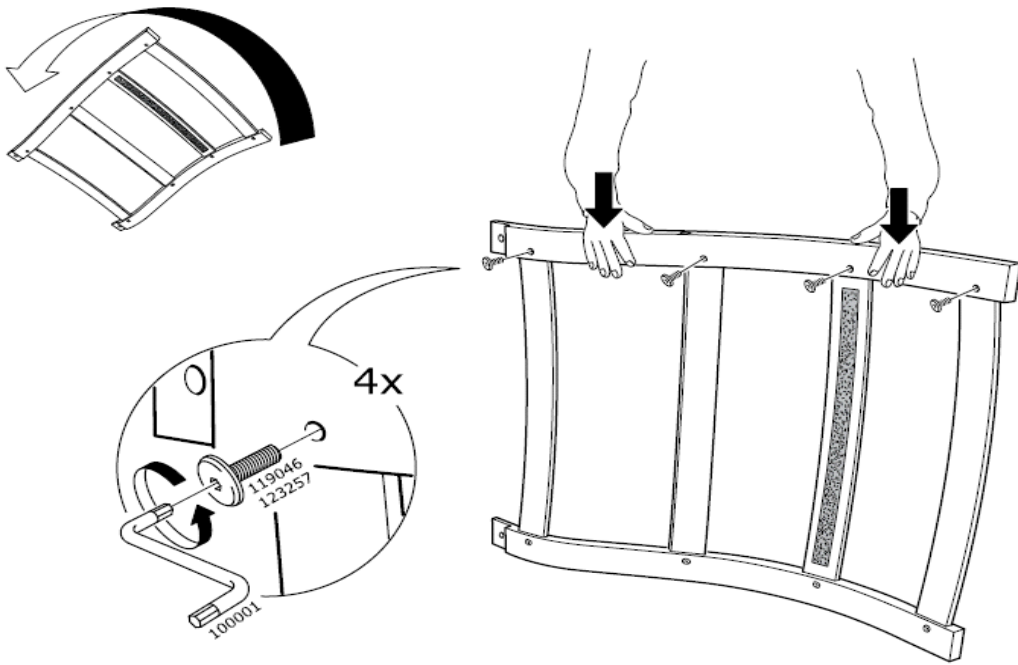

Step 4

Flip the assembly over and tighten the screws on the other side using Allen wrench (#100001)

5

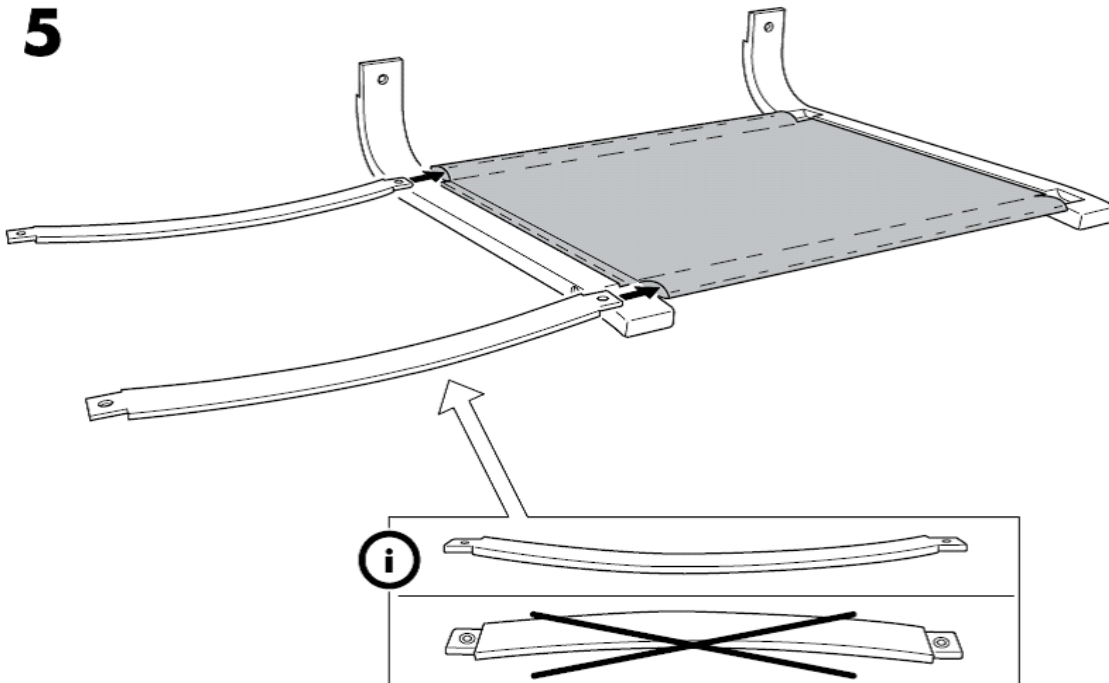

Step 5

- A. Slide two chair rails into the fabric for the chair. Make sure that the rails have the curve facing down as shown in picture (i) above.
- B. Insert the tabs of the chair rails into the chair side rails.

6

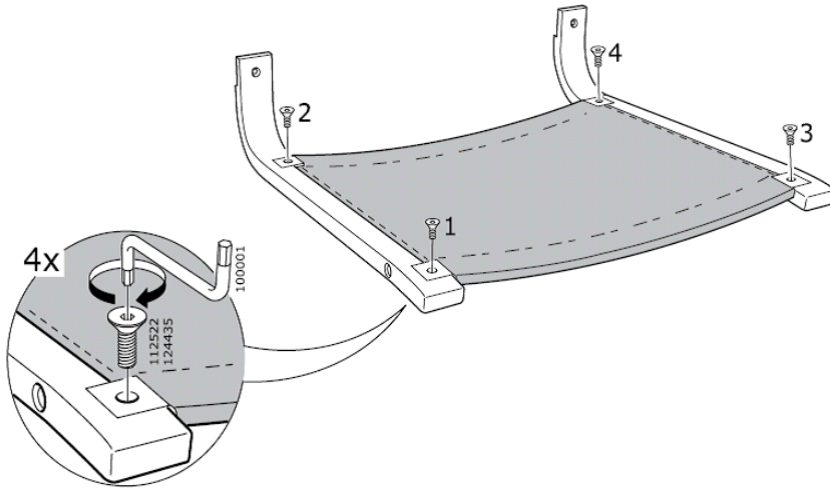

Step 6

Insert a tapered head screw (#112522) into the hole in the side chair rail and start threads by hand. Use the Allen wrench (#100001) to tighten the screw. Repeat for all 4 holes.

7

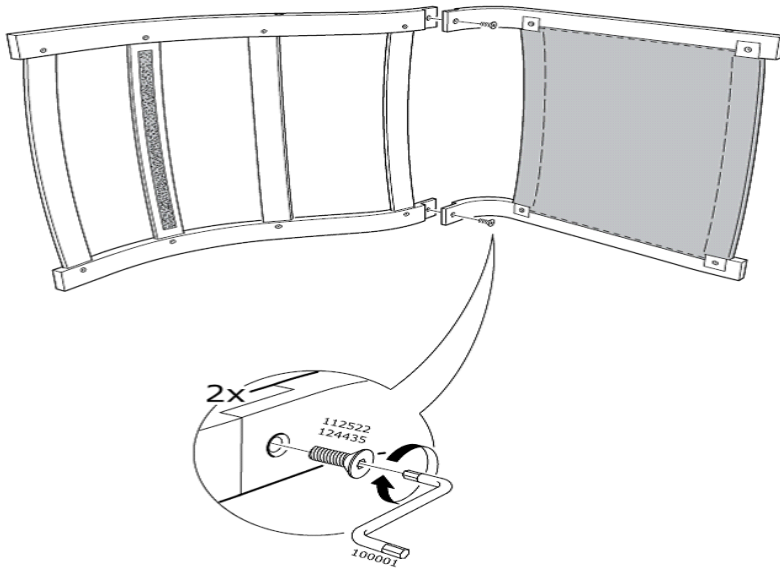

Step 7

Position the chair and backrest as shown above. Insert a tapered head screw (#112522) into the hole in the side chair rail and start threads by hand. Use the Allen wrench (#100001) to tighten the screw. Repeat this for both holes.

8

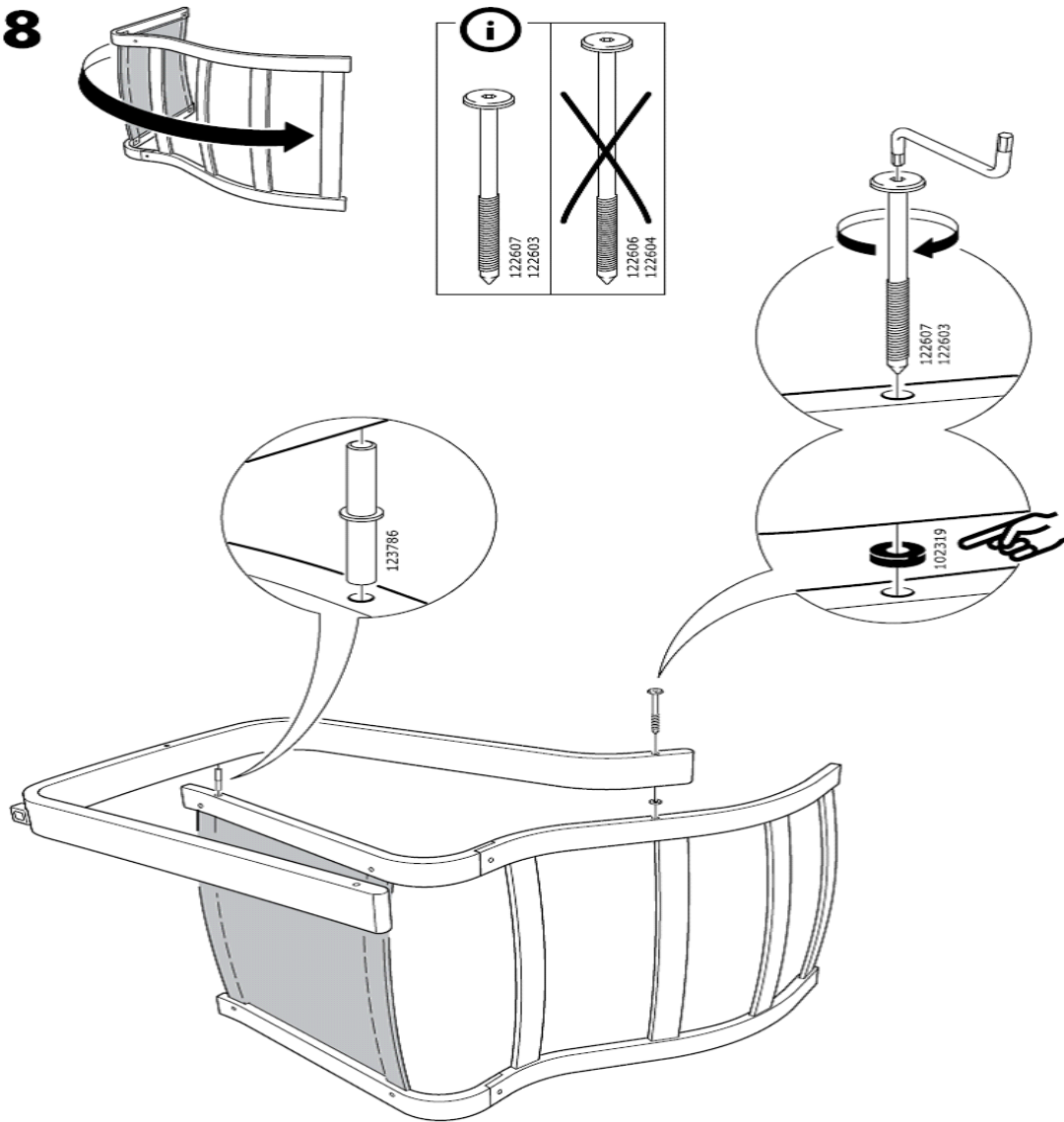

Step 8

- Position the chair and backrest assembly on its side.
- Insert the alignment pin (#123786) in the open hole on the chair.
- Mount the leg on the other end of the alignment pin. Rotate the leg until the other hole on the leg is lined up with the hole on the backrest.
- Insert washer (#102319) between the leg and backrest.
- Insert short shank screw (#122607) through the hole in the leg, through the washer, and into the backrest hole. Start threads by hand. Use the Allen wrench (#100001) to tighten the screw.

Note: Be sure to use the shorter of the two long screws as shown in picture (i) above.

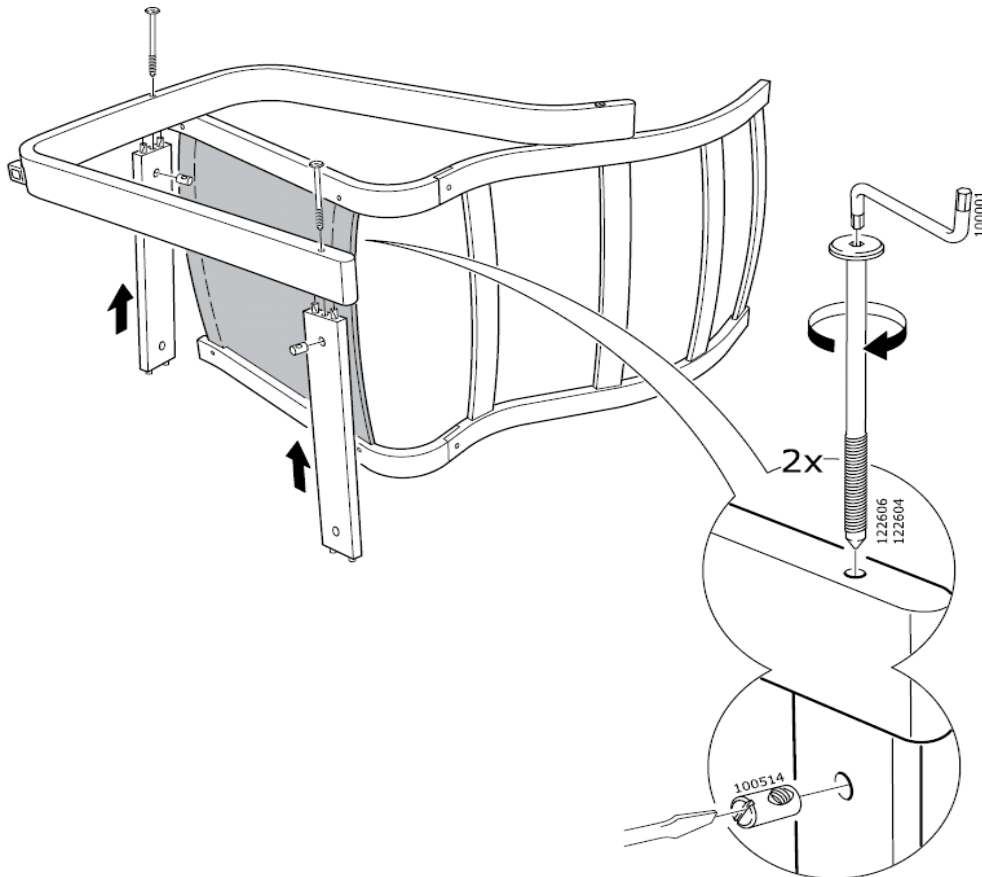
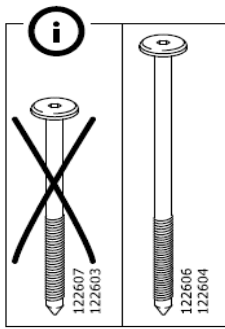
9

Step 9

- Obtain one of the support rails.
- Insert anchor nut (#100514) into one end with a flathead screwdriver.
- Insert the mounting tabs of the support rail into the corresponding holes on the chair leg.
- Insert long shank screw (#122606) into the hole in the leg. Push it down until you feel contact with the threaded insert in the support rail.
- Turn the anchor nut to align the threads with the long shank screw. Once aligned, start threads by hand. Use the Allen wrench (#100001) to tighten the screw.
- Repeat this procedure for the other support rail.

Note: Be sure to use the long shank screw as shown in picture (i) above.

10

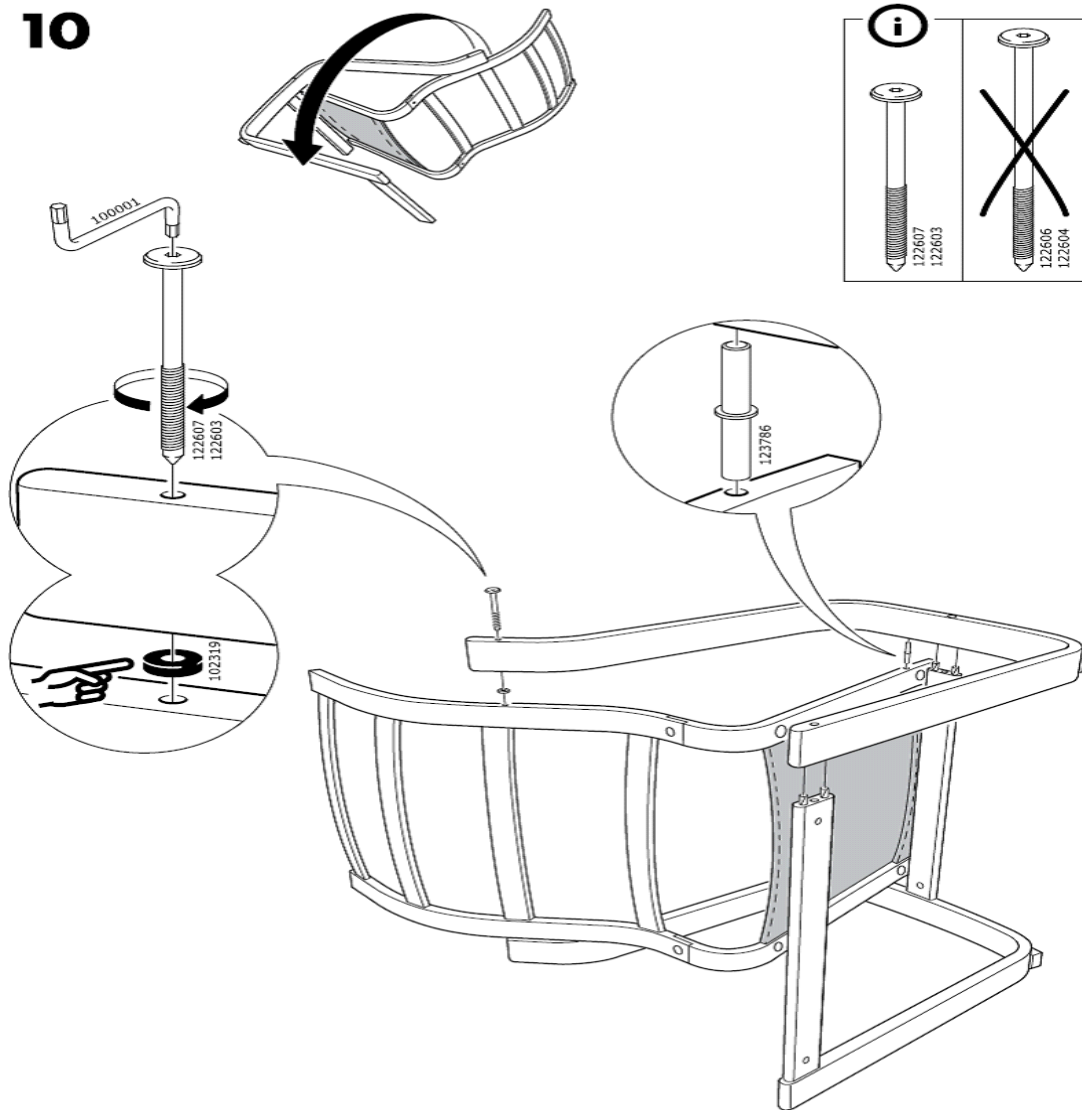

Step 10

- A. Flip the chair over on its other side.
- B. Insert alignment pin (#123786) in the open hole on the seat.
- C. Mount the leg on the other end of the alignment pin. Rotate the leg until the mounting tabs on the support rails and the hole on the backrest are aligned.
- D. Insert washer (#102319) between the leg and backrest.
- E. Insert short shank screw (#122607) through the hole in the leg, through the washer, and into the backrest hole. Start threads by hand. Use the Allen wrench (#100001) to tighten the screw.

Note: Be sure to use the short shank screw as shown in picture (i) above.

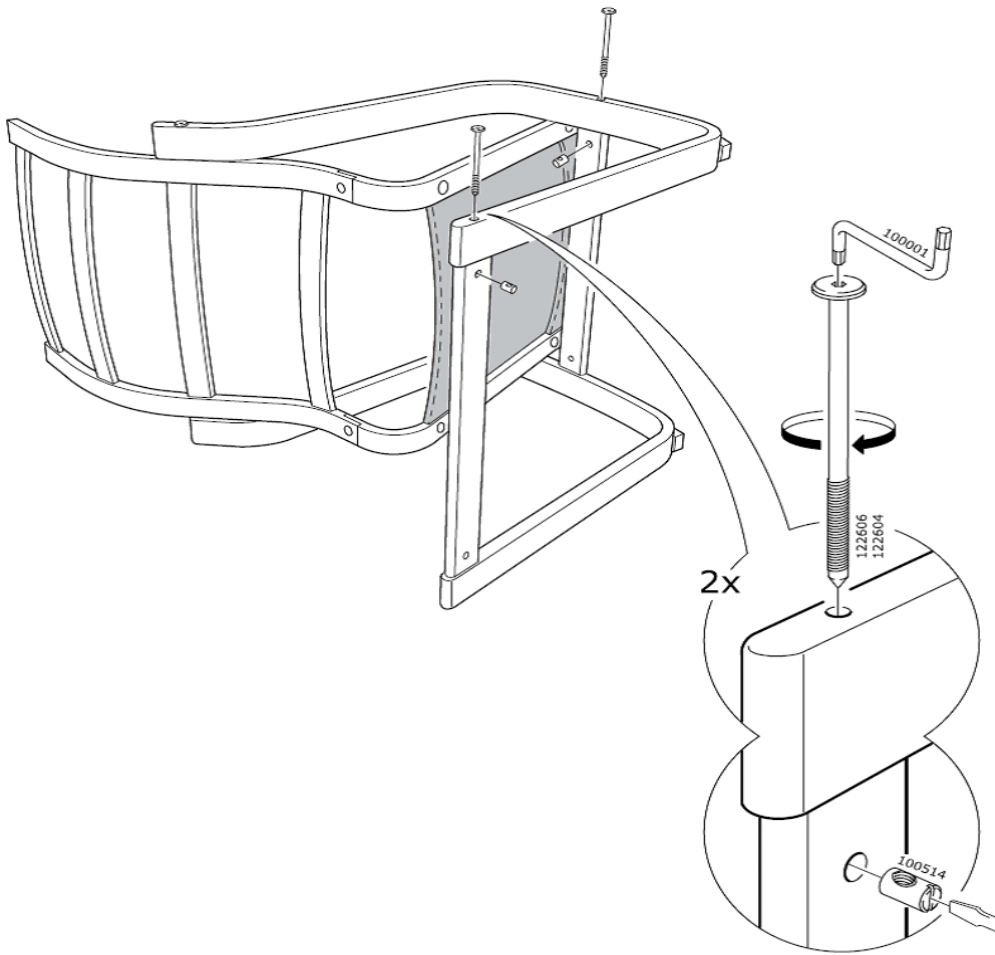

Step 11

- Insert anchor nut (#100514) into the open hole of the support rail with a flathead screwdriver.
- Insert long shank screw (#122606) into the hole in the leg. Push screw down until you feel contact with the anchor nut in the support rail.
- Turn the anchor nut to align the threads with the long shank screw. Once aligned, tighten screw by hand, Use Allen wrench (#10001) to tighten.
- Repeat this procedure for the other support rail.

Note: Be sure to use the long shank screw as shown in picture (i) above.

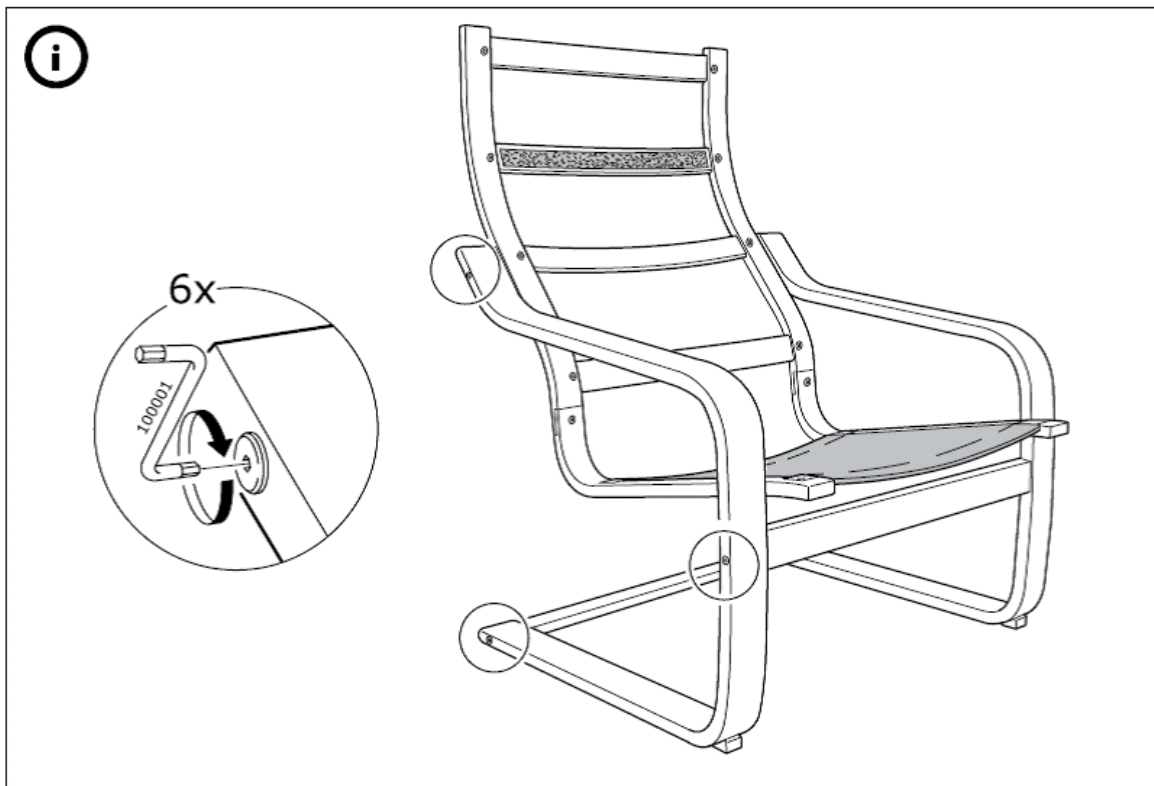

(i) Use Allen wrench (#100001) and ensure that the three fasteners circled above are tight. Check the fasteners on both sides of the chair. There are 6 fasteners total.



(i) Make sure that the grip strip on the cushion is aligned with the grip strip on the backrest.